

Thrust Washers

固体镶嵌自润滑垫片 PBG300.

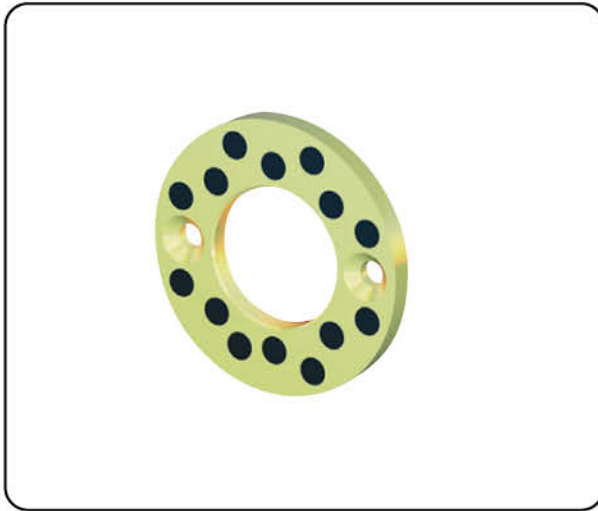

PBG300.

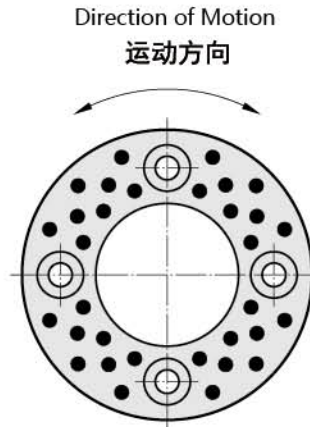

材料：铜合金，固体润滑剂

备注：可与 PBG100 轴套配合使用。

Material:
Bronze, graphite
oilless lubricating.

Note:
For combination loads use together
with Bushes PBG100

装配：

d3=10,2 2×M3
d3=20,2 2×M5
d3=40,2 2×M6
d3=50,3 4×M6
d3=60,3 4×M8
d3=90,5 4×M10
所供产品不配螺钉

Fixing:

from d3 = 10,2 2×M3
from d3 = 20,2 2×M5
from d3 = 40,2 2×M6
from d3 = 50,3 4×M6
from d3 = 60,3 4×M8
from d3 = 90,5 4×M10
Screws not included.

运动方向
Direction of
Motion

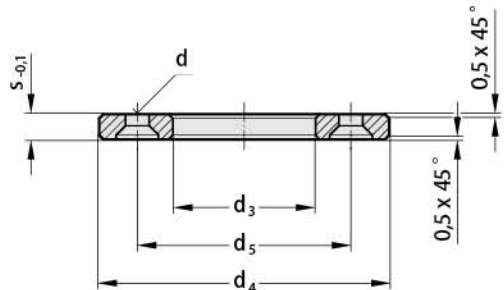

PBG300.

d ₃	10,2	12,2	13,2	16,2	18,2	20,2	25,2	30,2	35,2	40,2	45,3	50,3	55,3	60,3	65,3	70,3	80,3	90,5	100,5	120,5
d ₄	30	40	40	50	50	50	55	60	70	80	90	100	110	120	125	130	150	170	190	200
d ₅	20	28	28	28	35	35	40	45	50	60	67,5	75	85	90	95	100	120	140	160	175
s	3	3	3	3	3	5	5	5	5	7	7	8	8	8	8	10	10	10	10	10
d	3,5	3,5	3,5	3,5	3,5	6	6	6	6	7	7	7	7	9	9	9	9	11	11	11

订购代码（例）：

Ordering Code (example):

垫片 Thrust Washer = PBG300.

d₃ = 20,2 mm = 020

订购代码 Order No = PBG300.020